

- NOTE:
- SUBJECT TO DETAIL DESIGN OR CONSTRUCTION OF MISSISSAUGA ROAD FROM BOVAIRD DRIVE, THE EAST CURB LINE ESTABLISHED WILL BE THE REFERENCE STARTING POINT FOR THE FUTURE WIDENING OF MISSISSAUGA ROAD TO SIX (6) LANES.
 - THE LOCATION OF SIDEWALKS AND MULTI-USE PATHS WILL BE CONFIRMED DURING DETAIL DESIGN.

SERVICE DATA					
SERVICE	DATE	INIT.	SERVICE	DATE	INIT.
SAN SEWERS			GAS MAINS		
STORM SEWERS			BELL U/G CABLE		
WATERMANS			HYDRO U/G CABLE		
TRANSIT			ONT. HYDRO		
PARKS & REC.			CTV		
ONT. CLEAN WATER					

REVISIONS		
DATE	DETAILS	INIT.

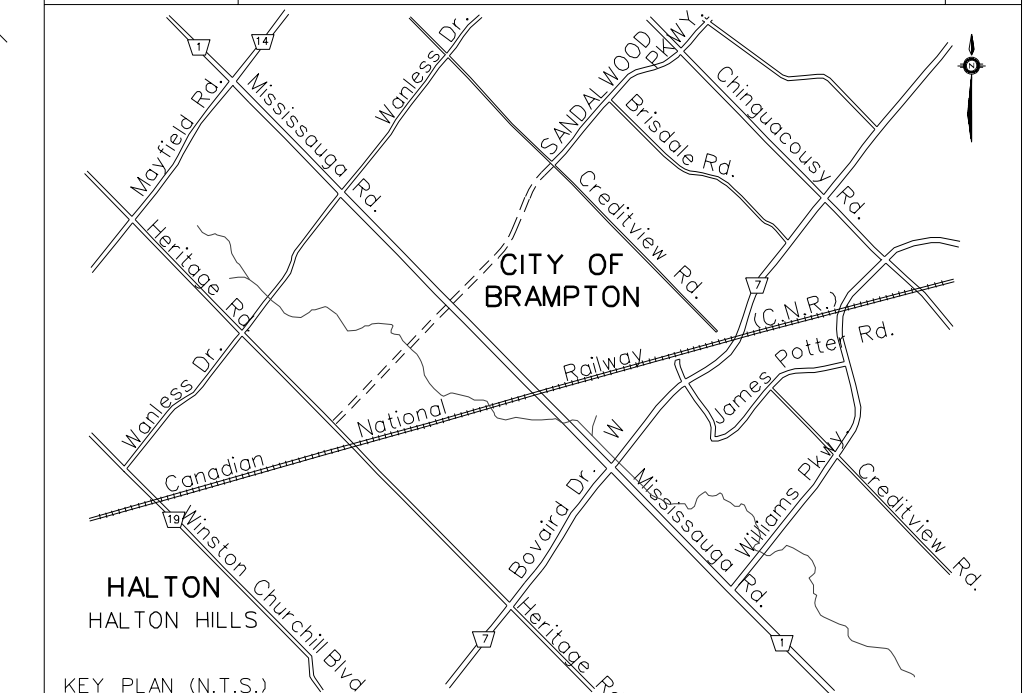

AECOM

AECOM CANADA LTD.
300 TOWN CENTRE BLVD., MARKHAM,
ONTARIO, CANADA L3R 5Z6
T905.477.8700 F905.477.1456

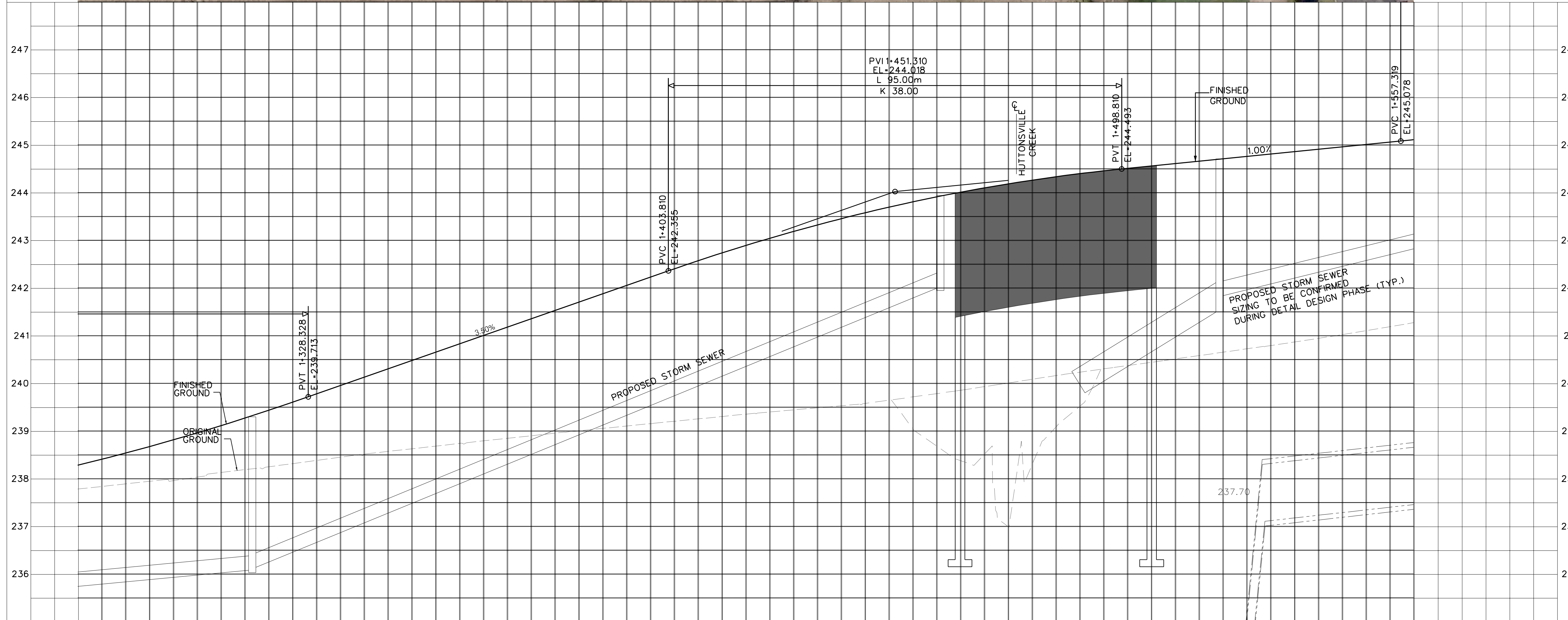

- General Notes
- All Driveways ASPHALT Unless Otherwise Noted.
 - All Service Locations Are Approximate And Must Be Located Accurately In The Field
 - Denotes Building - Not Located
 - Denotes Building Located
 - Type 'B' Bedding Unless Otherwise Noted (SAN)
- B.M. No. Elev.
- The Contractor is Responsible For Locating And Protecting All Existing Utilities Prior To And During Construction Location of Existing Utilities Approximate Only, To Be Verified In Field By Contractor.

Designed by	Chkd.	Approved by
-------------	-------	-------------

NOTICE TO CONTRACTOR
48 HOURS PRIOR TO COMMENCING WORK NOTIFY THE FOLLOWING

THE REGIONAL MUNICIPALITY OF PEEL
CITY OF MISSISSAUGA WORKS DEPT.
CITY OF BRAMPTON WORKS DEPT.
TOWN OF CALEDON WORKS DEPT.

BELL TELEPHONE COMPANY
CONSUMERS GAS COMPANY
MINISTRY OF TRANSPORTATION
ONTARIO CLEAN WATER AGENCY
HYDRO ELECTRIC POWER COMM. OF ONTARIO
HYDRO ELECTRIC COMM. CITY OF MISSISSAUGA
HYDRO ELECTRIC COMM. CITY OF BRAMPTON
CABLE TELEVISION

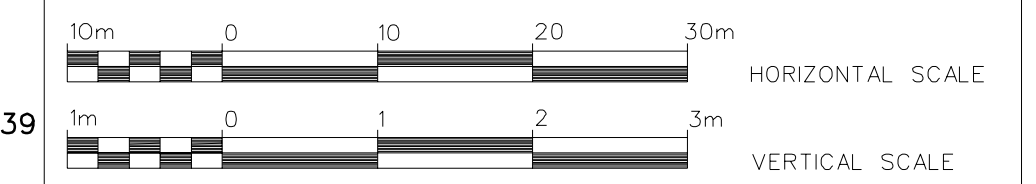

Region of Peel
Working for you

MISSISSAUGA ROAD
(FROM BOVAIRD DR. TO MAYFIELD RD.)
PLAN AND PROFILE

Sta. 1+280.00	To Sta. 1+560.00	PR. ROAD ELEV.	Lots	Area	Project No.											
238.279	238.810	239.429	240.122	240.822	241.522	242.222	242.887	243.450	243.906	244.258	244.505	244.705	244.905	245.106	PR. ROAD ELEV.	105163
239.41	240.13	240.96	241.89	242.88	243.79	244.56	245.21	245.72	246.11	246.36	246.56	246.76	246.99	247.34	EX. ROAD ELEV.	
1+280	1+300	1+320	1+340	1+360	1+380	1+400	1+420	1+440	1+460	1+480	1+500	1+520	1+540	1+560	ROAD CHAINAGE	

Checked by	P.C.	Drawn by	V.M.	Project No.	105163
Date	NOV 2012	Sheet	2 of 19	Plan No.	PP02